

CHAPTER 2

SOME INPUT EXAMPLES

A. Bazoune

1. EXAMPLES OF INITIAL CONDITIONS

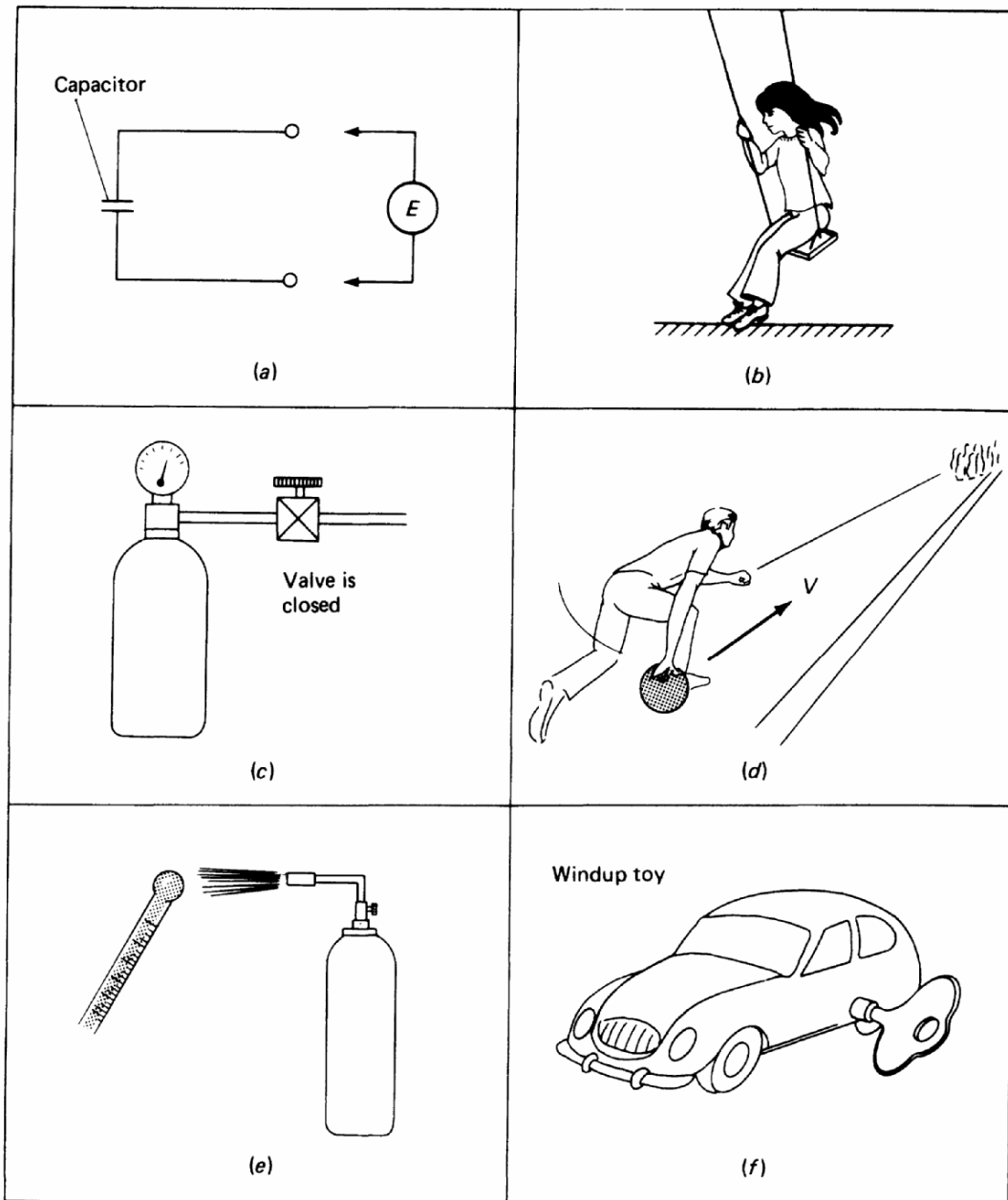

Figure 3.1.1-1 Some examples of initial conditions. (a) Initial charge. (b) Initial displacement. (c) Initial pressure. (d) Initial velocity. (e) Initial temperature. (f) Initial angular displacement.

2. EXAMPLES OF IMPULSE INPUTS

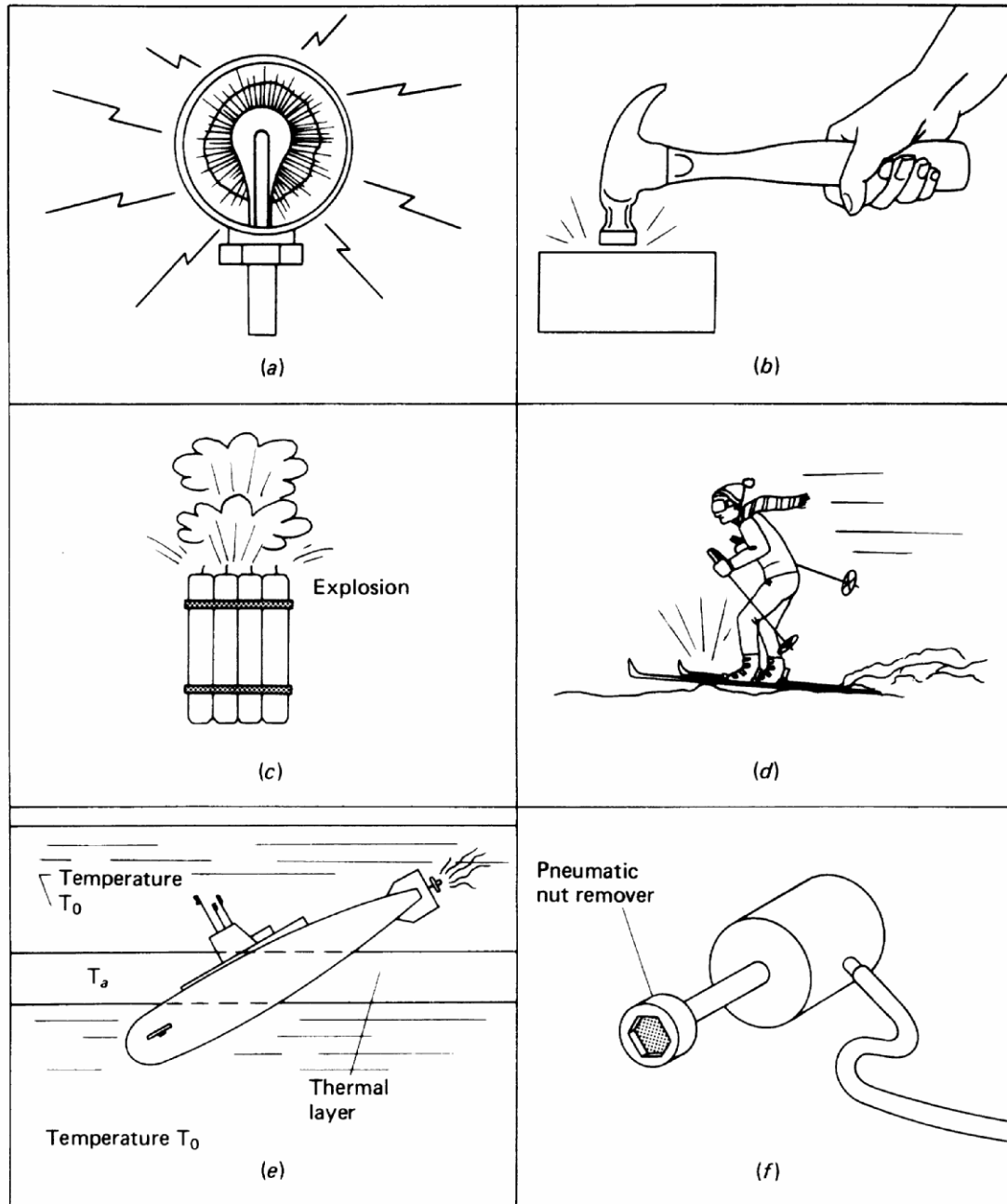

Figure 3.1.2-1 Some examples of impulse inputs. (a) Electronic flash gun. (b) Impulse force. (c) Impulse pressure. (d) Translatory impulse displacement. (e) Thermal shock. (f) Impulse torque.

3. EXAMPLES OF STEP INPUTS

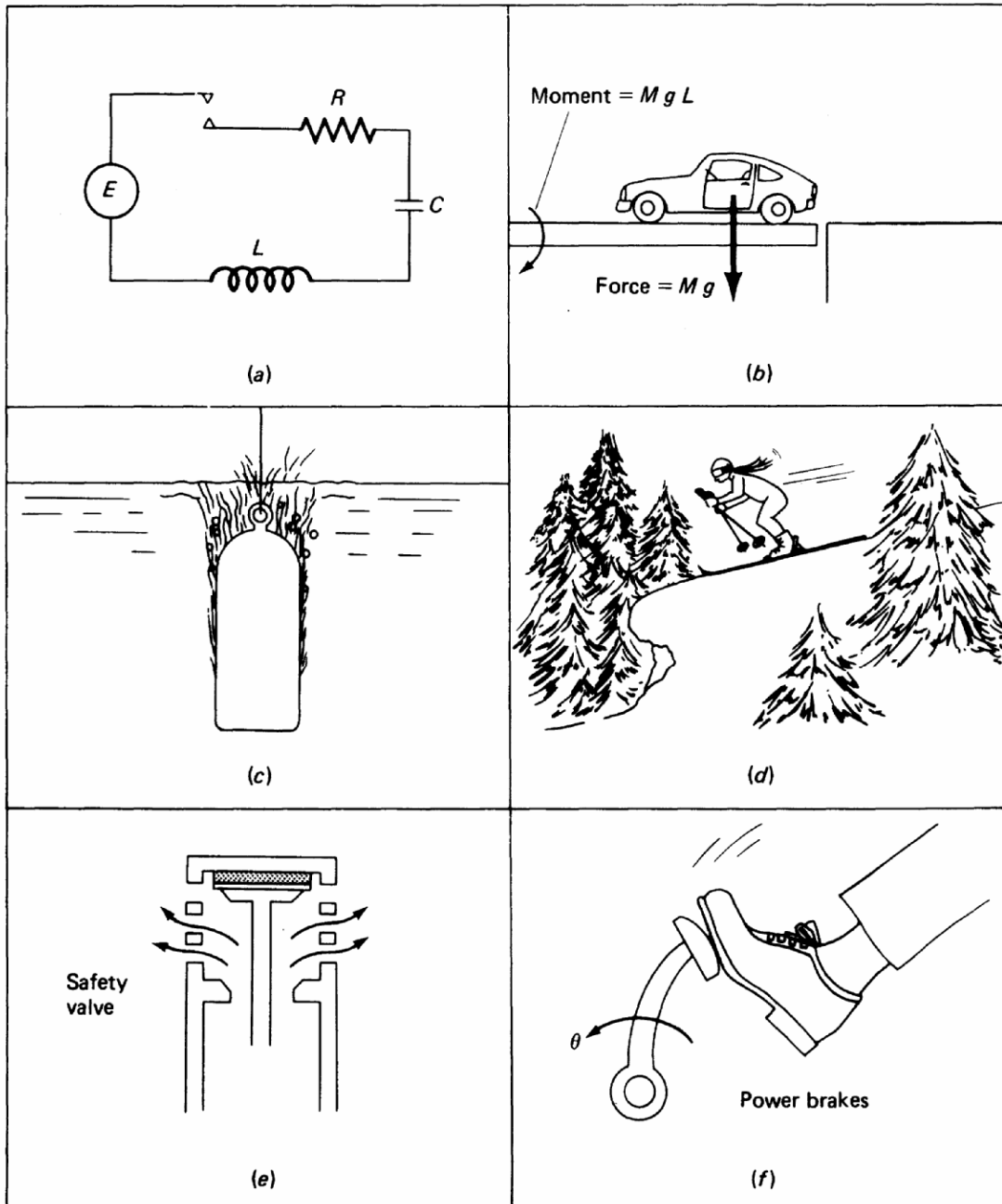

Figure 3.1.3-1 Some examples of step inputs. (a) Closing a switch. (b) Step force and step moment. (c) Quenching hot steel. (d) Translatory step displacement. (e) Step pressure. (f) Rotary step displacement.

4. EXAMPLES OF RAMP INPUTS

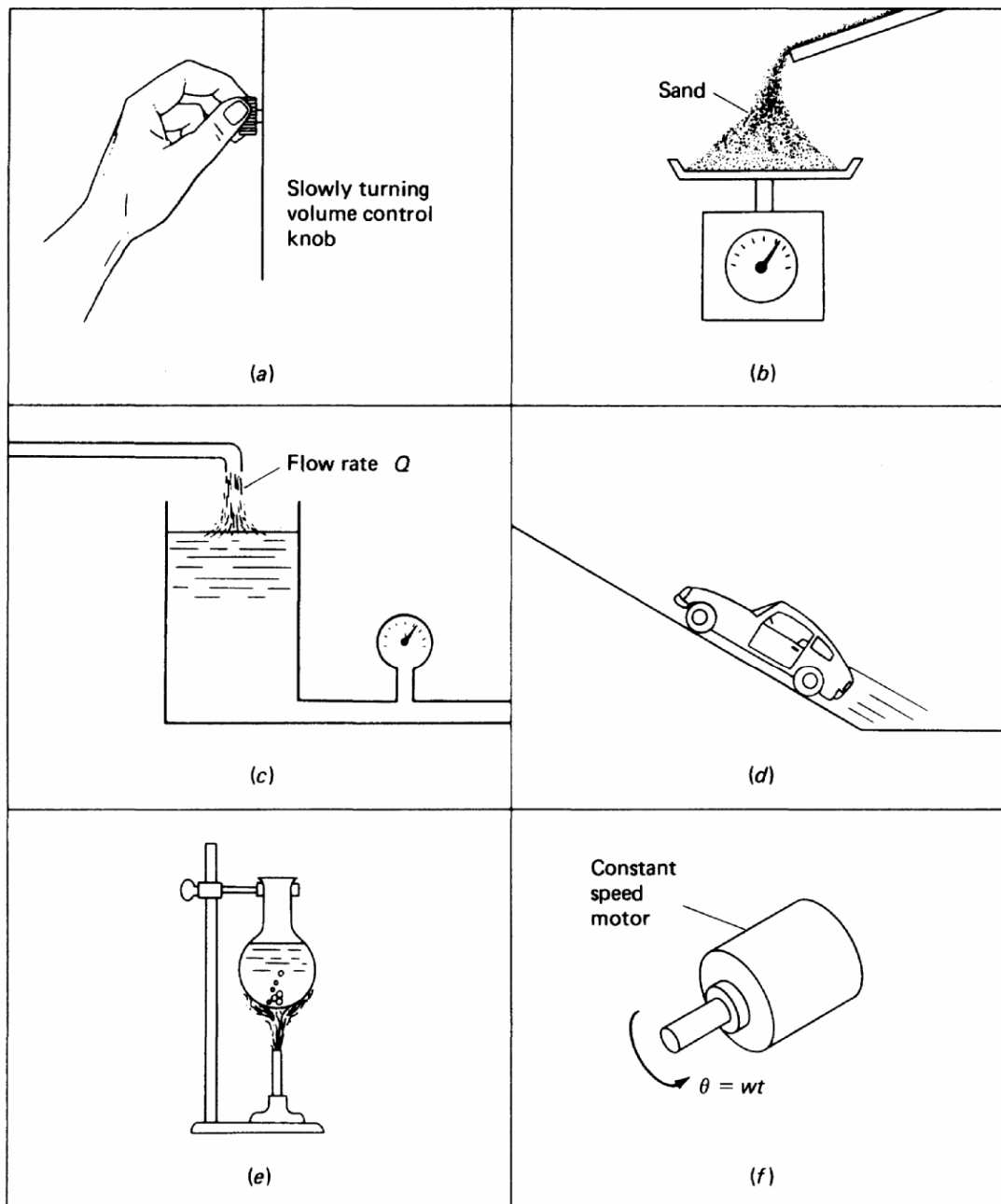

Figure 3.1.4-1 Some examples of ramp inputs. (a) Ramp voltage. (b) Ramp force. (c) Ramp pressure. (d) Translatory ramp displacement. (e) Constant temperature rise. (f) Rotary ramp displacement.