

SOLUTION OF HOMEWORK NO. 8:

F_{J1}, F_{J2}

F_{G1}, F_{G2}

PROB 6-35 (Text P 279)

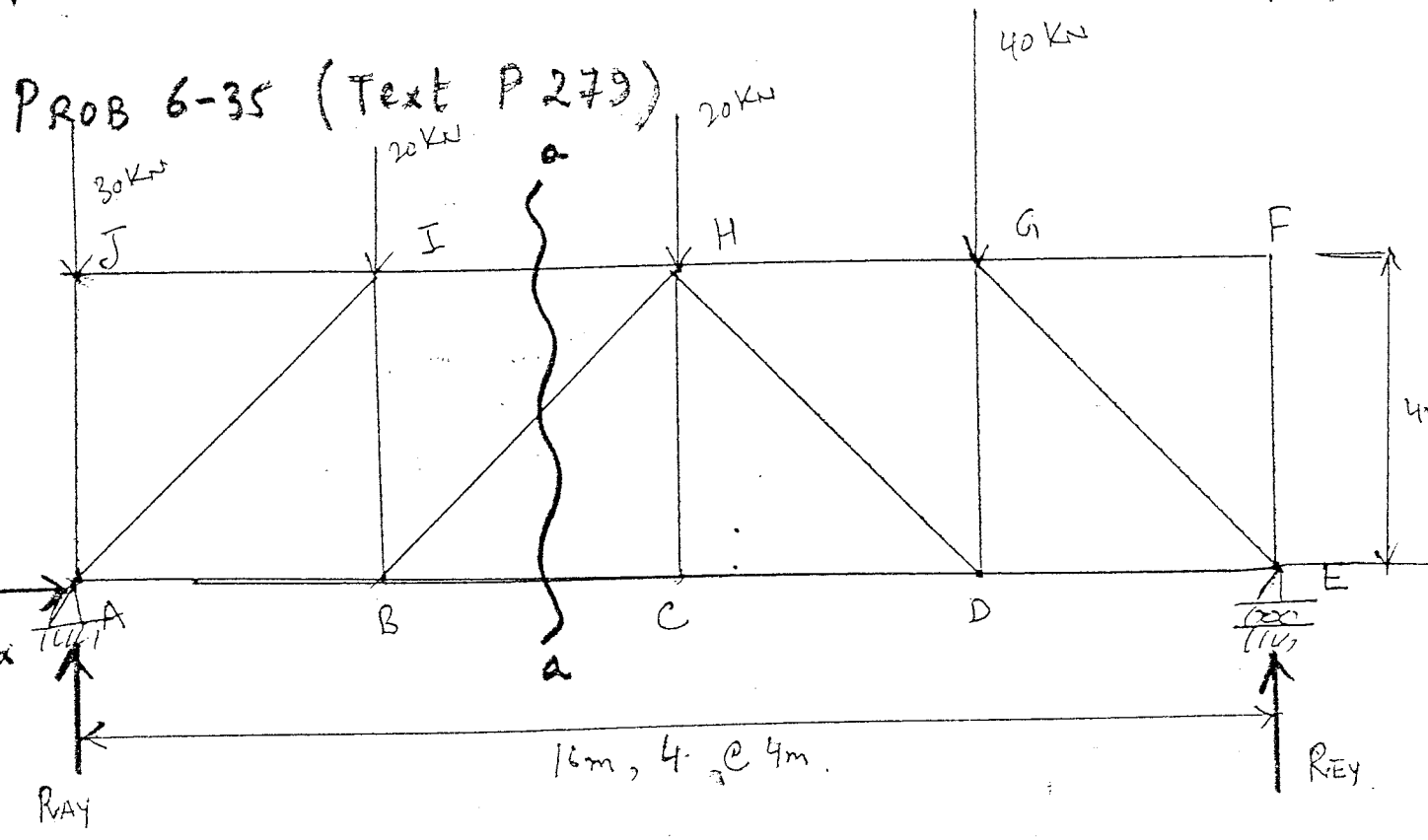

$\sum M_E = 0$

$$-R_{AY}(16) + 30(16) + 20(12) + 20(8) + 40(4) = 0$$

$\Rightarrow R_{AY} = 65 \text{ KN.}$

$\sum M_A = 0$

$$R_{EY}(16) = 40(12) + 20(8) + 20(4) = 0$$

$\Rightarrow R_{EY} = 45 \text{ KN}$